

This gasket uses our high shielding tin plated beryllium copper Spira-Shield as its base. We inject a liquid silicone adhesive into the center of the spiral, which hardens and bonds completely to the metal, making this gasket extremely durable when properly used.

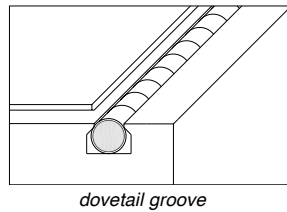

See page 51 for groove mounting techniques.

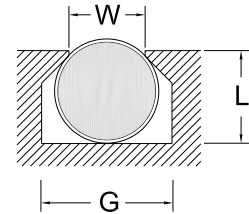

Outer Conductive Spiral:
Tin/Lead Plated Beryllium Copper



Resilient Inner Core:
Solid Silicone

| Enduro-Shield Part Numbers (Tin/Lead Plated Beryllium Copper) | | | | Recommended Groove Dimensions | | |
|--|----------------|----------------|-----------|-------------------------------|---------------------------|---------------------------|
| Diameter | Standard Force | Moderate Force | Low Force | Depth (L) +.002"-.000" | Width (G) +.007"-.005" | Width (W) +.000"-.002" |
| .034" ± .002" | SISS-02 | SIMS-02 | -- | .023" | .046" | .033" |
| .047" ± .002" | SISS-03 | SIMS-03 | -- | .035" | .063" | .045" |
| .063" ± .003" | SISS-04 | SIMS-04 | SILS-04 | .046" | .094" | .060" |
| .070" ± .003" | SISS-.070 | SIMS-.070 | SILS-.070 | .053" | .094" | .067" |
| .078" ± .003" | SISS-05 | SIMS-05 | SILS-05 | .059" | .109" | .075" |
| .094" ± .004" | SISS-06 | SIMS-06 | SILS-06 | .070" | .125" | .090" |
| .103" ± .004" | SISS-.103 | SIMS-.103 | SILS-.103 | .077" | .141" | .099" |
| .109" ± .004" | SISS-07 | SIMS-07 | SILS-07 | .082" | .156" | .105" |
| .125" ± .004" | SISS-08 | SIMS-08 | SILS-08 | .094" | .171" | .121" |
| .139" ± .005" | SISS-.139 | SIMS-.139 | SILS-.139 | .104" | .187" | .134" |
| .141" ± .005" | SISS-09 | SIMS-09 | SILS-09 | .105" | .187" | .134" |

See page 51 for groove mounting techniques.
Dovetail Groove Cutters detailed on page 36.

Application Information

Because of its durability, Enduro-Shield is ideal for groove-mounted sliding applications, such as in connectors. This gasket material is used in our Enduro-Shield O-rings. (See page 11.)

Materials

See page 59 for material specifications.

Spiral: Tin/lead plated beryllium copper. (See *Options* for RoHS compliance).
Electroplated, 90% tin, 10% lead (edges unplated).

Inner Core: Cured silicone adhesive.

Shielding Quality

This gasket offers shielding quality from 117 dB to 152 dB. The shielding quality may vary depending on your specific application. Refer to page 50 for more complete performance data.

Compression Force

Enduro-Shield gaskets come in three different resiliencies (as shown below). Optimal compression of the gasket is 25% of the diameter of the spiral. Since the force to compress the gasket is a function of the cube of the thickness of the beryllium copper ribbon, the compression forces shown are approximate. Some sizes are also available in low force. Please contact us for information.

Standard Force: ~30 pounds per linear inch compression.

Moderate Force: ~10 pounds per linear inch compression.

Low Force: ~1.5 pounds per linear inch compression.

Mounting

This gasket is groove mounted.

Available Options

Custom Sizes

We can manufacture Enduro-Shield gaskets in any size diameter, from .034" up to .141". There may be a nominal tooling charge for special sizes. Please contact us with your requirements.

Plating

See page 60 for material compatibility information.

Plating options can be specified by adding a prefix before the part number:

E: Edge tin/lead plating (includes edges) for high humidity or salt-fog environments

IW: RoHS compliant tin plating (Example: **IWSIMS-08**)

EIW: RoHS compliant edge tin plating for high humidity or salt-fog

Material

Stainless steel material may also be substituted if desired. Please see the following chart for part number options.

Specify material by choosing the desired prefix from the table.

Example:
SITNI-09
Tin Plated St. Steel
Standard Force

| Material | Force | No Plating | Tin/lead Plating | RoHS Tin | Edge Tin/Lead | RoHS Edge Tin |
|-------------------------|-----------------------------|----------------------|--------------------------------|----------------------------|-------------------------|-------------------------------|
| Beryllium Copper | Standard Moderate Low | -- | SISS (default) SIMS SILS | IWSISS IWSIMS IWSILS | ESISS ESIMS ESILS | EIWSISS EIWSIMS EIWSILS |
| Stainless Steel | Standard Moderate Low | SINI SINM SINL | SITNI SITNM SITNL | IWSINI IWSINM IWSINL | -- | -- |

Special Core

A special core can be specified by using the following option:

-F: Fluorosilicone (Example: **SIMS-08-F**)

-O: Silicone that meets outgassing requirements

-Z: Silicone which is a non-acetic acid adhesive (per MIL-A-46146)

Note: EMI/Environmental version in development. Contact us for more information.

Ordering Information

Enduro-Shield is sold by the piece in four foot lengths. It can be spliced together to make longer lengths upon request. Enduro-Shield can also be ordered cut-to-length in specific sizes or you can cut it yourself using a sharp pair of scissors. Not all configurations are stock items. Contact us for availability. To order o-rings please refer to the Enduro-Shield O-Ring section, or the Custom Gaskets section, page 37.